

CARATTERISTICHE FUNZIONAMENTO - OPERATING DATA - CARACTERISTIQUES DE FONCTIONNEMENT

Pompa tipo Pump type Pompe type	Aspir. x Mandata Inlet x Outlet Aspiration x Refout.	Giri p.d.f. x Rapporto p.t.o. R.P.M. x Gear ratio T/min p.d.f. x Rapport	Giri/min pompa R.P.M. pump T/min pompe	Girante Impeller Roue	Portata - Capacity - Débit [m ³ /h]												Potenza Trattore Tractor Power Puissance Tracteur [CV]				
					0	45	60	75	90	105	120	150	180	210	240	300					
					Portata - Capacity - Débit [l/min]																
					0	750	1000	1250	1500	1750	2000	2500	3000	3500	4000	5000					
Prevalenza - Head - Hauteur [m]																					
PTH 65	150 x 65	540 x 5,84 913 x 3,45	3150	C	H	108	103	101	99,4	97,6	95,5	93,4	87,4	78,4					100 - 110		
					CV	53,5	60	62,4	65,1	68,7	72,5	76,2	81,6	85,2							
					B	H	116	111	109	108	106	104	101	95,9	87,1						
				CV	60	66,9	69,5	72,4	76	80,1	84,3	90,4	94,5								
				A	H	125	120	118	116	114	112	109	104	95							125 - 135
				CV	67	74,4	77,1	80,2	83,9	88,3	92,8	99,9	105								
PTH 80N	100 x 80	540 x 5,84	3150	A	H	69,4	63,4	61	58,6	56	53,3	50,5	45,1					65 - 75			
					CV	31	36	39	40	42	48	49,5	56								
PTH 100	150 x 100	540 x 5,84	3150	A	H	59		58,5	58	57,5	57	56	53	50	46,6	41		70 - 80			
					CV	23,9		33	36	39	40	42	48	50	55,4	61					
PTH 100K		540 x 4,44 916 x 2,62	2400	D	H	107		105	105	104	102	101	97,6	91,6	84,2	76,2	55,4	170 - 180			
					CV	69,9		82,4	85,7	89,1	92,8	96,6	104	113	121	128	140				
				C	H	116		115	114	114	112	111	108	104	96,7	89,1	71	195 - 205			
					CV	79,7		92,6	96,1	99,6	103	107	115	124	133	141	154				
PTH 100KK	927 x 2,75	2550	C	H	132		130	130	129	128	126	123	119	112	105	86,7	230 - 240				
				CV	95,6		110	114	118	122	126	135	145	155	164	181					

CV = Potenza assorbita in [CV] - Absorbed power in [HP] - Puissance absorbée en [CV]

CARATTERISTICHE FUNZIONAMENTO - OPERATING DATA - CARACTERISTIQUES DE FONCTIONNEMENT

Pompa tipo Pump type Pompe type	Aspir. x Mandata Inlet x Outlet Aspiration x Refoull.	Giri. p.d.f. x Rapporto p.t.o. R.P.M. x Gear ratio T/min p.d.f. x Rapport	Giri/min pompa R.P.M. pump T/min pompe	Portata - Capacity - Débit [m ³ /h]														Potenza Trattore Tractor Power Puissance Tracteur [CV]	
				0	36	72	108	144	180	216	252	288	324	360	390	429	468		
				Portata - Capacity - Débit [l/min]															
				0	600	1200	1800	2400	3000	3600	4200	4800	5400	6000	6500	7150	7800		
				Prevalenza - Head - Hauteur [m]															
PTH 150	200 x 150	540 x 4,44 916 x 2,62	2400	H	51,1	49,5	47,8	46,4	44,4	42,5	40,6	38,7	36,7	34,4	31,7	28	23,5	11,1	120 - 130
				CV	74,3	75,9	76,2	76,7	77,8	79,3	81,4	83,8	86,8	90,7	95,3	98,8	101,2	99,8	

CV = Potenza assorbita in [CV] - Absorbed power in [HP] - Puissance absorbée en [CV]

Pompa tipo Pump type Pompe type	Passaggio libero Free passage Passage libre Ø [mm]
PTH 65	11
PTH 80N	28
PTH 100	28
PTH 100K	28
PTH 100KK	28
PTH 150	40

CURVE - CURVES - COURBES

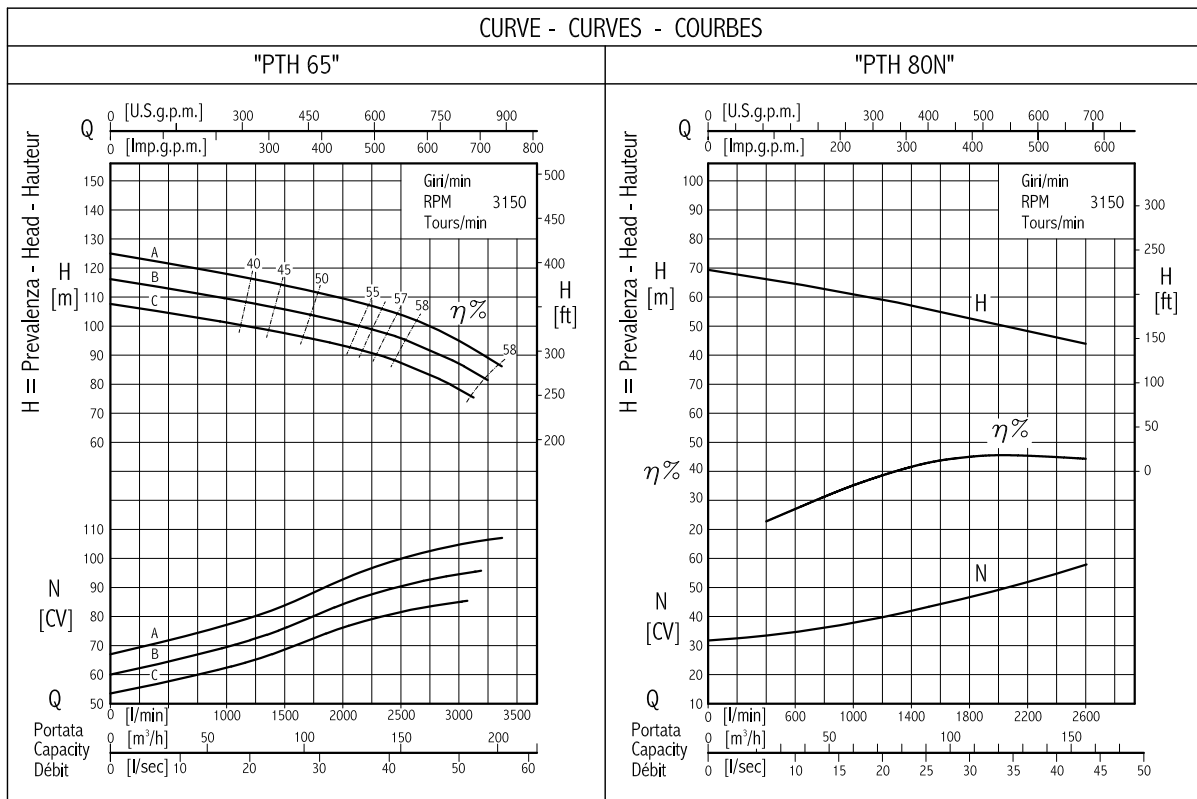

Curve per liquidi aventi densità 1-viscosità 1 mm²/s - alla temperatura di 20° C.
 Curves tested on liquid density 1- viscosity 1 mm²/s- temperature 20° C.
 Courbes établies pour liquides densité 1- viscosité 1 mm²/s - température 20° C.

Potenza assorbita [CV] | Rendimento pompa
 N = Absorbed power [HP] | $\eta\%$ = Pump efficiency
 Puissance absorbée [CV] | Rendement pompe

CURVE - CURVES - COURBES

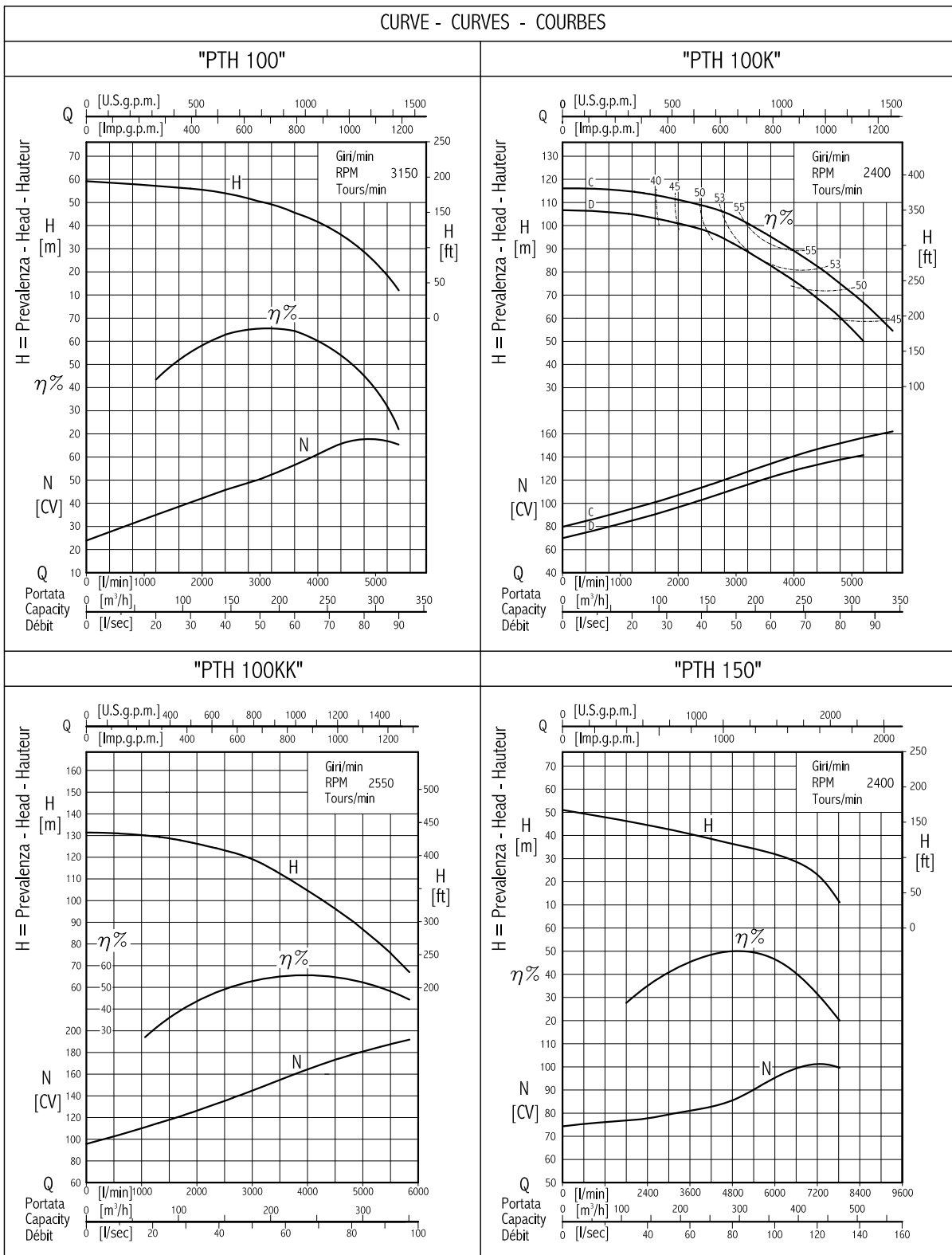

Curve per liquidi aventi densità 1 - viscosità 1 mm²/s - alla temperatura di 20° C.
 Curves tested on liquid density 1 - viscosity 1 mm²/s - temperature 20° C.
 Courbes établies pour liquides densité 1 - viscosité 1 mm²/s - température 20° C.

Potenza assorbita [CV] | Rendimento pompa
 N = Absorbed power [HP] | η% = Pump efficiency
 Puissance absorbée [CV] | Rendement pompe

CARATTERISTICHE STANDARD

Max contenuto sostanze solide in sospensione 12%, esclusi i modelli 65, 100K e 100KK a contenuto max 8%.
 Liquido pH 5 - 12.
 Max temperatura del liquido pompato 60° C.

STANDARD FEATURES

Max solid content in the liquid 12%; 65, 100K and 100KK models excluded, max solid content 8%.
 Liquid pH 5 - 12.
 Max temperature of pumped liquid 60° C.

CARACTERISTIQUES STANDARD

Max contenu de substances solides en suspension 12%, modèles 65, 100K et 100KK exclu, max contenu 8%.
 Max pH du liquide 5 - 12.
 Max température du liquide pompé 60° C.

PTH 65
 PTH 100
 PTH 100K
 PTH 100KK
 PTH 150

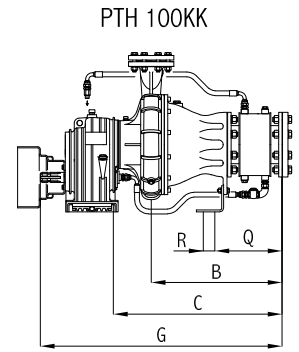
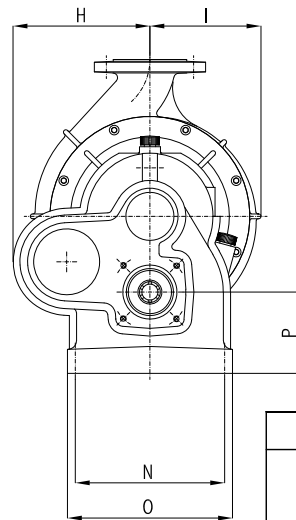
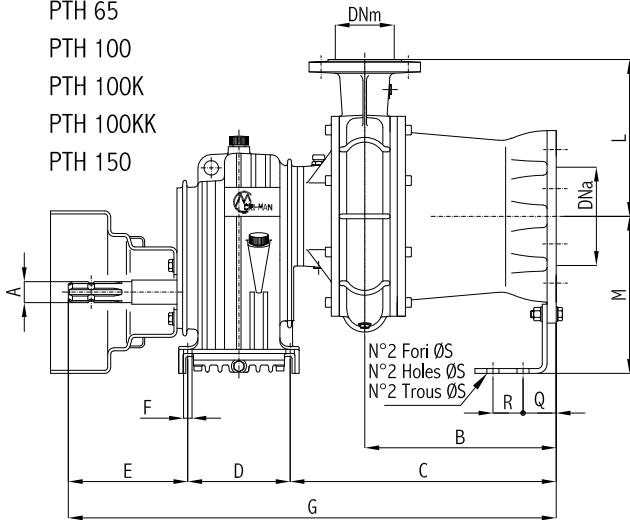

Flangia - Flange - Bride					
DN	T	U	V°	Ø Fori Ø Holes Ø Trous	N°Fori N°Holes N°Trous
DN65-PN10	185	145	90°	18	4
DN80-PN10	200	160	90°	18	4
DN100-PN10/16	220	180	45°	18	8
DN150-PN10/16	285	240	45°	22	8
DN200-PN10	340	295	45°	22	8

PTH 80N

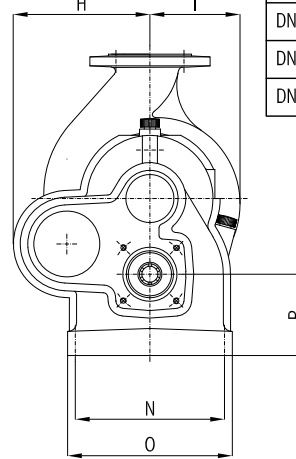
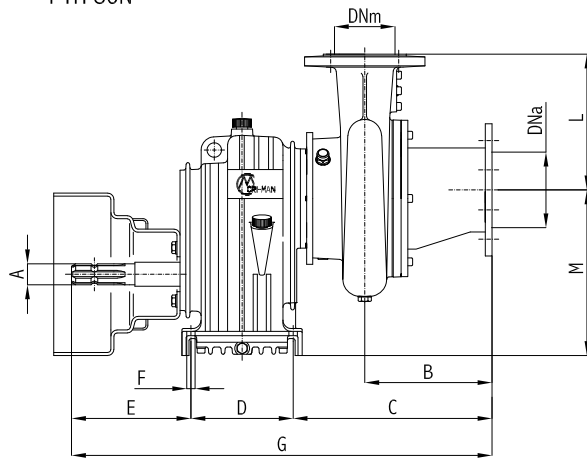

Flangia UNI
 Flange UNI
 Bride UNI

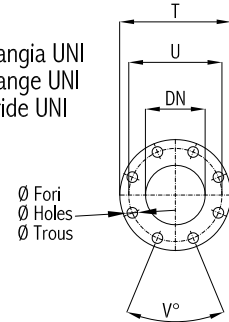

Pompa tipo Pump type Pompe type	DIMENSIONI INGOMBRO [mm] - OVERALL DIMENSIONS [mm] - DIMENSIONS [mm]																		
	DNa	DNm	A	B	C	D	E	F	G	H	I	L	M	N	O	P	Q	R	ØS
PTH 65	DN150-PN10	DN65-PN10	1 ³ / ₈ z = 6	318	442	170	199	14	811	199	184	261	261	248	274	135	55	50	13
PTH 80N	DN100-PN10	DN80-PN10		258	377				746	177	150	226	275				-	-	-
PTH 100	DN150-PN10	DN100-PN10/16		293	419				788	190	155	263	261						
PTH 100K			335	501	895	248	229	370	55	13									
PTH 100KK	DN150-PN10	DN100-PN10/16	1 ³ / ₄ z = 6	574	743	190	133	16	1066	296	265	300	152	298	50	13			
PTH 150			DN200-PN10	DN150-PN10/16	1 ³ / ₈ z = 6	263	409	204	803	257	198	340	55						

Alberi cardanici - Drive shafts - Arbres a cardan

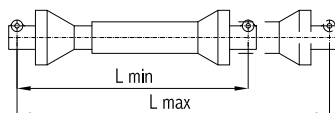

Tipo Type	L min	L max	[CV]	
			540	1000
C 60	1010	1550	64	100
C 95	1010	1540	95	150
C 95K			-	

Potenza trasmissibile in [CV]
 [CV] = Transmissible power in [HP]
 Puissance transmissible en [CV]

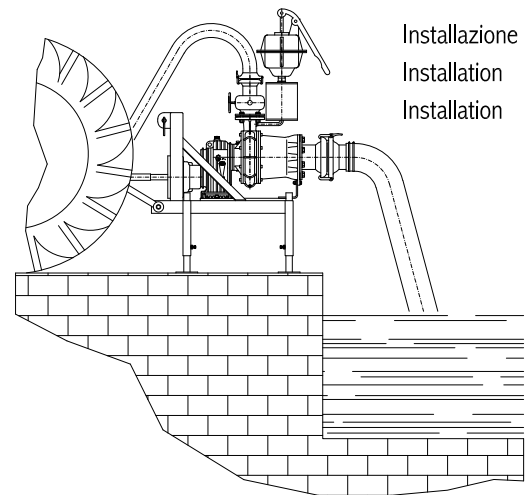

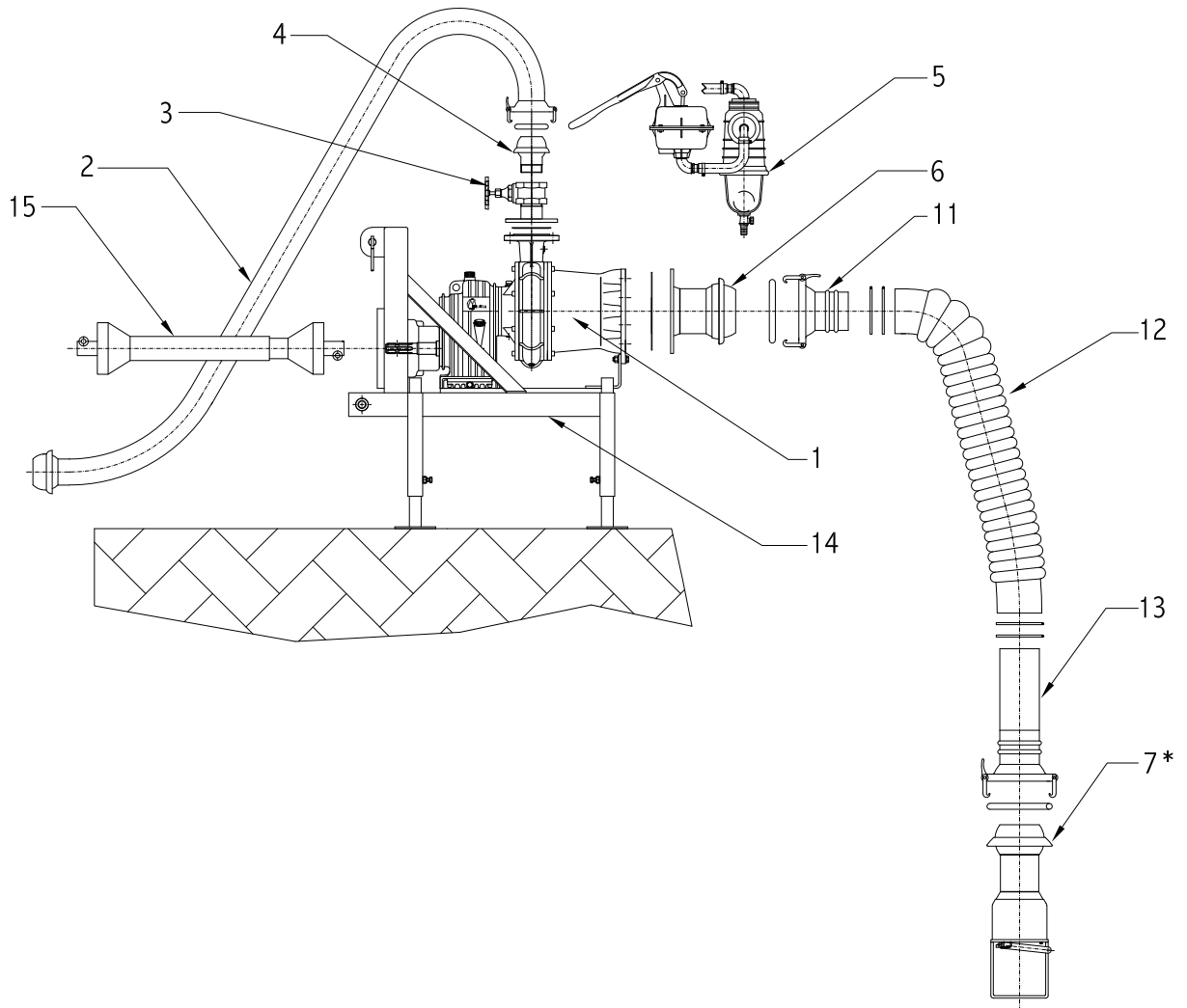

DESCRIZIONE

- 1 Pompa
- 2 Collo di cigno
- 3 Saracinesca flangiata
- 4 Maschio con tronchetto filettato
- 5 Dispositivo adescamento
- 6 Raccordo maschio con flangia
- 7 Valvola di fondo a clapet*
- 11 Portagomma con raccordo femmina
- 12 Tubo flessibile in gomma
- 13 Prolunga con raccordo femmina
- 14 Telaio
- 15 Albero cardanico

* Impiegare solo per acque reflue con solidi in sospensione a pezzatura regolare, quali fanghi di depurazione, liquidi melmosi, liquame suino, ecc...

DESCRIPTION

- 1 Pump
- 2 Gooseneck
- 3 Flanged gate
- 4 Male with threaded stud pipe
- 5 Priming device
- 6 Male with flange
- 7 Foot valve*
- 11 Female hose connection
- 12 Rubber flexible hose
- 13 Female coupling extension
- 14 Frame
- 15 Drive shaft





* Use only for waste water with regular sized suspended solids such as sewage sludge, waste and muddy water in general, muddy liquid, pig slurry, etc...

DESCRIPTION

- 1 Pompe
- 2 Col-de-cygne
- 3 Vanne bridée
- 4 Mâle avec tube fileté
- 5 Dispositif d'amorçage
- 6 Mâle avec bride
- 7 Clapet*
- 11 Raccord femelle
- 12 Tuyau flexible
- 13 Extension avec raccord femelle
- 14 Chassis
- 15 Arbre a cardan

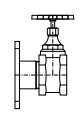
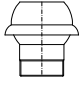
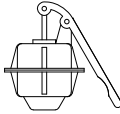
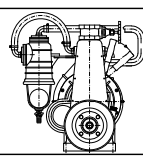
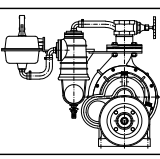
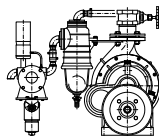
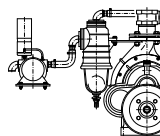
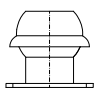
* Employer seulement avec liquides chargés avec solides en suspension de granulométrie régulière tels que boues d'épuration et liquides boueux en général, lisier de porc, etc...

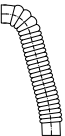
ACCESSORI DISPONIBILI - AVAILABLE ACCESSORIES - ACCESSOIRES DISPONIBLES

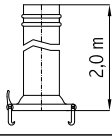
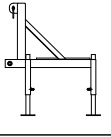
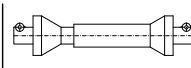
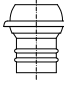
	2	3	4	--	5	5	
Pompa tipo Pump type Pompe type	Collo di cigno Gooseneck Col-de-cygne 	Saracinesca flangiata Flanged gate Vanne bridée 	Maschio con tronchetto filett. Male with thread Male avec tube fileté 	Pompa a membrana Diaphragm pump Pompe à membrane 	Disp. adescamento automatico Automatic priming device Dispositif d'amorçage automatique 	Disp. adescamento manuale Manual priming device Dispositif d'amorçage manuel 	
PTH 65	CCM 80	SFF 65/10	MS 80/3	PAM	ADA	ADM	
PTH 80N	CCM 100	SFF 80/10-3	MS 100/3				
PTH 100	CCM 120	SFF 100/10	MS 120/4				
PTH 100K							
PTH 100KK							--
PTH 150							CCM 150
Pompa tipo Pump type Pompe type	5 Disp. adescamento idraulico Hydraulic priming device Dispositif d'amorçage hydraulique 	5 Disp. adescamento elettrico Electric priming device Dispositif d'amorçage électrique 	6 Maschio con flangia Male with flange Male avec bride 	7 Valvola fondo* Foot valve* Clapet* 	11 Portagomma con racc. femmina Female hose connection Raccord femelle 	12 Tubo flessibile in gomma Rubber spiral hose Tuyau flexible 	
PTH 65	ADI	ADE	FS 150	V 150	D 150 F D 150 FZ	SPIG 150	
PTH 80N			FS 100-150				
PTH 100			FS 150				
PTH 100K							
PTH 100KK							
PTH 150							FS 200
Pompa tipo Pump type Pompe type	-- Fascetta per tubo flessibile Clamp PVC hose Collier pour tuyau flexible 	13 Prolunga con raccordo femmina Female coupling extension Extension avec raccord femelle 	14 Telaio Frame Châssis 	15 Albero cardanico Drive shaft Arbre à cardan 	-- Portagomma con racc. maschio Male hose connection Raccord mâle 		
PTH 65	FIS 150	DE 150 F	T65	C	C 60	D 150 M D 150 MZ	
PTH 80N				B / A	C 95		
PTH 100				A	C 60		
PTH 100K				A	C 95		
PTH 100KK				D / C / B / A			
PTH 150				FIS 200	DE 200 F		A